

## ONE-TOUCH FITTINGS

> METRIC SYSTEM

### PKG reducer triple branch union

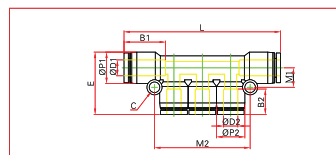

MODEL	ØD1	ØD2	L	B1	B2	ØP1	ØP2	M1	M2	ORIFICE
PKG 06-04	6	4	50.5	15	15	13	11	8	34	32
PKG 08-04	8	4	53	15	15	14.4	11	9.0	34.4	42
PKG 08-06	8	6	80	18	15	14.4	13	9.0	40.6	32
PKG 10-06	10	6	80	22	15	18.4	14.4	10.5	42	42
PKG 10-08	10	8	70	22	18	18.4	14.4	10.5	47	42

## ONE-TOUCH FITTINGS

> INCH SYSTEM

### PKG reducer triple branch union

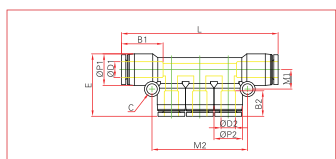

MODEL	ØD1	ØD2	ØP1	ØP2	L	E	C	B1	B2	M1	M2	ORIFICE
PKG 3/16-5/32	3/16	5/32	11	11	60.5	26.3	4.2	15	15	7.6	34.0	3.2
PKG 1/4-5/32	1/4	5/32	13	11	61.6	26.6	4.2	15	15	8.8	36.0	3.2
PKG 5/16-5/32	5/16	5/32	14.4	11	65.6	28.2	4.2	18	15	9.2	34.8	3.2
PKG 5/16-3/16	5/16	3/16	14.4	11	68.7	28.9	4.2	18	15	9.3	41.1	4
PKG 5/16-1/4	5/16	1/4	14.4	13	71.9	30	4.2	18	15	9.7	43.5	5
PKG 3/8-1/4	3/8	1/4	18.4	13	74.2	32.2	4.2	22	15	11.0	43.5	5
PKG 3/8-5/16	3/8	5/16	18.4	14.4	83.6	34.5	4.2	22	18	8.5	47.0	6