

## ONE-TOUCH FITTINGS

> METRIC SYSTEM

### PUC union straight

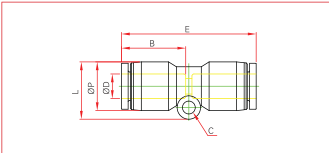

MODEL	ØD	E	C	B	ØP	ORIFICE
PUC 04	4	32.6	3.2	15	11	3
PUC 06	6	35	3.2	15	13	5
PUC 08	8	36.5	3.2	18	14.4	6
PUC 10	10	47.6	4.2	22	18.4	8
PUC 12	12	48.8	4.2	22	21	10
PUC 16	16	64.8	5.2	24	26	13

## ONE-TOUCH FITTINGS

> INCH SYSTEM

### PUC union straight

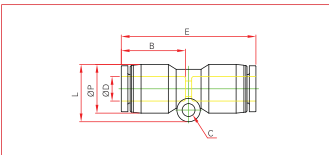

MODEL	ØD	ØP	L	E	C	B	ORIFICE
PUC 5/32	5/32	11	12.8	32.6	3.2	15	3
PUC 3/16	3/16	13	15.1	35	3.2	15	5
PUC 1/4	1/4	13	16.3	35	3.2	15	5
PUC 5/16	5/16	14.4	19.9	38.6	3.2	18	6
PUC 3/8	3/8	18.4	21.5	47.6	4.2	22	8
PUC 1/2	1/2	21	24.5	48.8	4.2	22	10