

ONE-TOUCH FITTINGS

> METRIC SYSTEM

PLM bulkhead union elbow

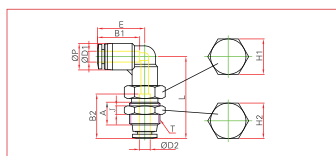

MODEL	ØD1	ØD2	ØP	T	L	E	A	B1	B2	J	H1 (hex)	H2 (hex)	ORIFICE
PLM 04	4	4	11	M12×P1.0	32.4	18.7	9.0	15	15	4.0	14	14	3.0
PLM 06	6	6	13	M14×P1.0	36.2	20.4	11.0	15	15	4.0	17	17	4.5
PLM 08	8	8	14.4	M16×P1.0	40.3	23.1	11.5	18	18	5.0	19	19	6.0
PLM 10	10	10	18.4	M20×P1.0	42.3	23.7	12.0	22	22	5.0	24	24	7.0
PLM 12	12	12	21	M22×P1.0	48.1	27.7	15.0	22	22	5.0	26	26	10.0

ONE-TOUCH FITTINGS

> INCH SYSTEM

PLM bulkhead union elbow

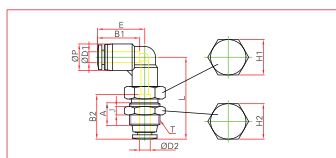

MODEL	ØD1	ØD2	P	T	L	E	A	B1	B2	J	H1	H2	ORIFICE
PLM 5/32	5/32	5/32	11	M12 x P1.0	32.4	18.7	9.0	16.3	16.3	4.0	14	14	3.0
PLM 3/16	3/16	3/16	13	M14 x P1.0	34.7	19.2	10.0	16.9	16.9	4.0	17	17	3.0
PLM 1/4	1/4	1/4	13	M14 x P1.0	38.8	20.5	11.0	17.4	17.4	4.0	17	17	4.5
PLM 5/16	5/16	5/16	14.4	M16 x P1.0	40.3	23.1	11.5	19.1	19.1	5.0	19	19	6.0
PLM 3/8	3/8	3/8	18.4	M20 x P1.0	42.2	23.8	12.0	19.8	19.8	5.0	24	24	7.0
PLM 1/2	1/2	1/2	21	M22 x P1.0	48.4	28.3	15.0	23.0	23.0	5.0	26	26	9.0