

## ONE-TOUCH FITTINGS

### > METRIC SYSTEM

## PHF female banjo

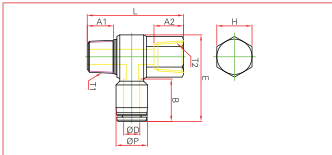

MODEL	ØD	ØP	T1	T2	L	E	A1	A2	B	H (Hex)	ORIFICE
PHF 04-01	4	11	PT1/8	PT1/8	30.2	30.5	8.0	8.0	15	14	3.0
PHF 04-02	4	11	PT1/4	PT1/4	35.5	34.5	10.0	10.0	15	17	3.2
PHF 04-M5	4	11	M5×P0.8	M5×P0.8	20.0	25.1	3.6	7.0	15	8	1.5
PHF 04-M6	4	11	M6×P1.0	M6×P1.0	25.0	30.5	4.1	7.0	15	11	2.0
PHF 06-01	6	13	PT1/8	PT1/8	30.2	31.2	8.0	8.0	15	14	3.0
PHF 06-02	6	13	PT1/4	PT1/4	35.5	35.0	10.0	10.0	15	17	4.0
PHF 06-03	6	13	PT3/8	PT3/8	41.2	38.7	11.0	11.0	15	21	5.0
PHF 06-04	6	13	PT1/2	PT1/2	50.0	44.9	14.0	14.0	15	24	5.0
PHF 06-M5	6	13	M5×P0.8	M5×P0.8	20.0	27.8	3.6	7.0	15	8	1.5
PHF 06-M6	6	13	M6×P1.0	M6×P1.0	25.0	31.2	4.1	7.0	15	11	2.0
PHF 08-01	8	14.4	PT1/8	PT1/8	30.2	33.0	8.0	8.0	18	14	3.0
PHF 08-02	8	14.4	PT1/4	PT1/4	35.5	36.8	10.0	10.0	18	17	4.0
PHF 08-03	8	14.4	PT3/8	PT3/8	41.2	40.1	11.0	11.0	18	21	5.0
PHF 08-04	8	14.4	PT1/2	PT1/2	50.0	45.8	14.0	14.0	18	24	6.0
PHF 10-01	10	18.4	PT1/8	PT1/8	30.2	35.0	8.0	8.0	22	14	3.0
PHF 10-02	10	18.4	PT1/4	PT1/4	35.5	38.0	10.0	10.0	22	17	4.0
PHF 10-03	10	18.4	PT3/8	PT3/8	41.2	42.2	11.0	11.0	22	21	5.0
PHF 10-04	10	18.4	PT1/2	PT1/2	50.0	47.5	14.0	14.0	22	24	6.0
PHF 12-02	12	21	PT1/4	PT1/4	35.5	40.8	10.0	10.0	22	17	4.0
PHF 12-03	12	21	PT3/8	PT3/8	41.2	45.9	11.0	11.0	22	21	5.0
PHF 12-04	12	21	PT1/2	PT1/2	50.0	50.1	14.0	14.0	22	24	6.0

## ONE-TOUCH FITTINGS

### > INCH SYSTEM

## PHF female banjo

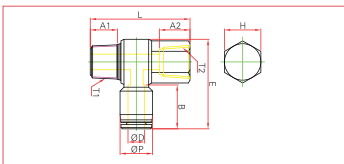

MODEL	ØD	ØP	T1	T2	L	E	A1	A2	B	H	ORIFICE
PHF 5/32-UNF	5/32	11	UNF 10/32	UNF 10/32	20.0	25.1	3.6	7.0	15	5/16	1.5
PHF 5/32-N01	5/32	11	NPT 1/8	NPT 1/8	30.9	30.5	8.5	8.5	15	9/16	3.0
PHF 3/16-UNF	3/16	13	UNF 10/32	UNF 10/32	20.0	26.6	3.6	7.0	15	5/16	1.5
PHF 3/16-N01	3/16	13	NPT 1/8	NPT 1/8	30.9	31.4	8.5	8.5	15	9/16	3.0
PHF 3/16-N02	3/16	13	UNF 1/4	UNF 1/4	35.8	35.3	10.5	10.5	15	11/16	4.0
PHF 3/16-N03	3/16	13	NPT 3/8	NPT 3/8	41.0	39.1	11.5	11.5	15	7/8	5.0
PHF 1/4-UNF	1/4	13	UNF 10/32	UNF 10/32	20.0	28.7	3.6	7.0	15	5/16	2.5
PHF 1/4-N01	1/4	13	NPT 1/8	NPT 1/8	30.9	32.0	8.5	8.5	15	9/16	3.0
PHF 1/4-N02	1/4	13	NPT 1/4	NPT 1/4	35.8	35.9	10.5	10.5	15	11/16	4.0
PHF 1/4-N03	1/4	13	NPT 3/8	NPT 3/8	41.0	39.7	11.5	11.5	15	7/8	5.0
PHF 5/16-N01	5/16	14.4	NPT 1/8	NPT 1/8	30.9	33.0	8.5	8.5	16	9/16	3.0
PHF 5/16-N02	5/16	14.4	NPT 1/4	NPT 1/4	35.8	36.8	10.5	10.5	16	11/16	4.0
PHF 5/16-N03	5/16	14.4	NPT 3/8	NPT 3/8	41.0	40.1	11.5	11.5	16	7/8	5.0
PHF 5/16-N04	5/16	14.4	NPT 1/2	NPT 1/2	50.0	45.8	14.5	14.5	16	1	6.0
PHF 3/8-N02	3/8	18.4	NPT 1/4	NPT 1/4	35.8	37.5	10.5	10.5	22	11/16	4.0
PHF 3/8-N03	3/8	18.4	NPT 3/8	NPT 3/8	41.0	42.1	11.5	11.5	22	7/8	5.0
PHF 3/8-N04	3/8	18.4	NPT 1/2	NPT 1/2	50.0	47.3	14.5	14.5	22	1	6.0
PHF 1/2-N03	1/2	21	NPT 3/8	NPT 3/8	41.0	45.1	11.5	11.5	22	7/8	5.0
PHF 1/2-N04	1/2	21	NPT 1/2	NPT 1/2	50.0	50.5	14.5	14.5	22	1	6.0