

SKA-RB Tube bend weld nipple

EO 24° O-ring weld nipple / butt weld

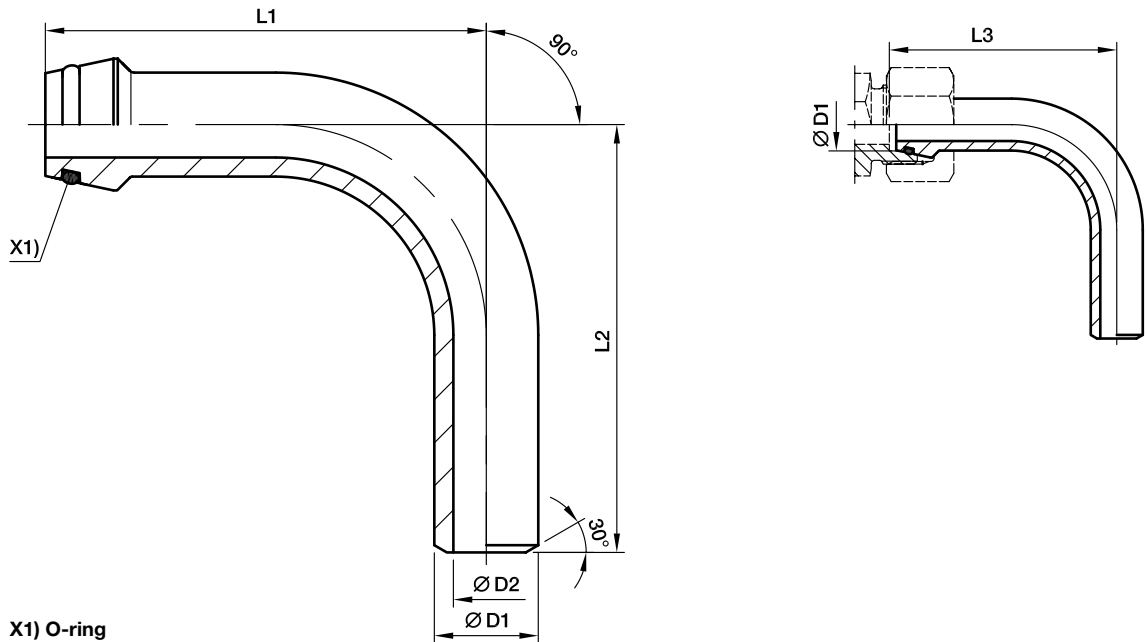

X1) O-ring

| Series | D1 | D2 | L1 | L2 | L3 | recommended tube | Weight g/1 piece | Order code | PN (bar) ¹⁾ | |
|-----------------|----|----|-----|-----|-------|------------------|------------------|--------------------|------------------------|-----------------|
| | | | | | | | | | Steel | Stainless Steel |
| S ⁴⁾ | 10 | 6 | 49 | 45 | 50.0 | 10×2.0 | 38 | SKA10X2RB | 460 | 447 |
| | 12 | 7 | 51 | 50 | 52.0 | 12×2.5 | 50 | SKA12X2.5RB | 476 | 463 |
| | 16 | 10 | 67 | 60 | 68.5 | 16×3.0 | 105 | SKA16X3RB | 400 | 400 |
| | 20 | 12 | 85 | 65 | 87.0 | 20×4.0 | 217 | SKA20X4RB | 400 | 400 |
| | 25 | 17 | 85 | 85 | 88.5 | 25×4.0 | 295 | SKA25X4RB | 379 | 369 |
| | 25 | 15 | 85 | 85 | 88.5 | 25×5.0 | 353 | SKA25X5RB | 400 | 400 |
| | 30 | 22 | 111 | 110 | 116.0 | 30×4.0 | 469 | SKA30X4RB | 323 | 314 |
| | 30 | 20 | 111 | 110 | 116.0 | 30×5.0 | 568 | SKA30X5RB | 393 | 383 |
| | 38 | 28 | 136 | 130 | 143.5 | 38×5.0 | 876 | SKA38X5RB | 315 | 315 |
| | 38 | 26 | 136 | 130 | 143.5 | 38×6.0 | 1045 | SKA38X6RB | 315 | 315 |

¹⁾Pressure shown = item deliverable

⁴⁾S = heavy series

$$\frac{\text{PN (bar)}}{10} = \text{PN (MPa)}$$



*Please add the **suffixes** below according to the material/surface required.

| Order code suffixes | | | |
|---------------------|-----------------------------|-------------|---|
| Material | Suffix surface and material | Example | Standard sealing material (no additional suffix needed) |
| Steel | | SKA16X3RB | NBR |
| Stainless Steel | 71 | SKA16X3RB71 | VIT |