

FEATURES

- Same housing for all ranges
- Mechanical stops in option
- Optional :
Tension Pull Plate
Load Button
- Integrated amplifier optional

APPLICATIONS

- Process control equipment
- Regulation load cell
- Robotics and effectors
- Laboratory and Research
- Dedicated to low and medium quantity volume

FN3050

Load Cell Tension and Compression

SPECIFICATIONS

- Range from 100 N to 20000 N (20 lbf to 4000 lbf)
- Accuracy: 0.1% F.S.
- Stainless steel or aluminum
- Connector or cable gland output
- Build in amplifier per request

The rugged **FN3050** load cell is highly suited for process industry and test bench applications. Dimensions are identical in standard ranges from 0-100 N to 0-20000 N so during testing the sensor can be interchanged for another of a different range without mechanical modifications. The sensor design minimizes transverse effects. For high-level output a model with integrated amplifier is available as are numerous other options.

With many years of experience as a designer and manufacturer of sensors, TE CONNECTIVITY often works with customers to design or customize sensors for specific uses and testing environments.

To meet your needs we also offer complete turnkey systems. The matched components (sensor, power, amplifier and digital display) are formatted, calibrated and ready for immediate use.

On request, Instruction documents can be provided to ease the selection and use of our sensors and provide helpful tips.

STANDARD RANGES

| | | | | | | | | |
|----------------------------|---------------------|---------------------|---------------------|---------------------|---------------------|---------------------|---------------------|---------------------|
| Ranges in N (FS) | 100 | 200 | 500 | 1k | 2k | 5k | 10k | 20k |
| Ranges in lbf | 20 | 40 | 100 | 200 | 400 | 1k | 2k | 4k |
| Stiffness in N/m | 1x10 ⁶ | 2.5x10 ⁶ | 1x10 ⁷ | 1.7x10 ⁷ | 5x10 ⁷ | 1.2x10 ⁸ | 2x10 ⁸ | 4x10 ⁸ |
| Stiffness in lbf/ft | 6.9x10 ⁴ | 1.7x10 ⁵ | 6.9x10 ⁵ | 1.2x10 ⁶ | 3.4x10 ⁶ | 8.2x10 ⁶ | 1.4x10 ⁷ | 2.7x10 ⁷ |
| Material | Aluminium | | | Stainless Steel | | Aluminium | Stainless Steel | |

PERFORMANCE SPECIFICATIONS (typical values at temperature 23±3°C)

| PARAMETERS | |
|-------------------------------------|---|
| Operating Temperature Range (OTR) | -20 to 80° C [-4 to 176° F] |
| Compensated Temperature Range (CTR) | 0 to 60° C [32 to 140° F] |
| Thermal Zero Shift in CTR | <0.5% F.S. / 50° C [/100° F] |
| Thermal Sensitivity Shift in CTR | <1 % of reading / 50° C [/100° F] |
| Over-Range | |
| Without Damage | 1.5 x F.S. (10 x F.S. with optional mechanical stops) |
| Without Destruction | 3 x F.S. |

| Accuracy | |
|---------------------------------------|---|
| Ranges in N | 100 200 500 1k 2k 5k 10k 20k |
| Ranges in lbf | 20 40 100 200 400 1k 2k 4k |
| Linearity (%F.S.) | - - 0.1 0.1 0.1 0.1 0.1 0.1 |
| Hysteresis (%F.S.) | - - 0.1 0.1 0.1 0.1 0.1 0.1 |
| Combined linearity & hysteresis (%FS) | 0.3 0.3 - - - - - - |

Electrical Characteristics

| Model | FN3050 | FN3050-A1 | FN3050-A2 |
|--------------------------------|---------------|-------------------|------------------------|
| Supply Voltage | 10Vdc | 10 – 30Vdc | ±15Vdc (±12 to ±18Vdc) |
| Sensitivity "FSO" ⁴ | ±1.5mV/V | ±2V ±0.2V | ±5V ±0.2V |
| Zero Offset ⁴ | ±5% F.S. | 2.5V ±0.2V | 0V ±0.2V |
| Input Impedance/Consumption | 350 to 700Ω | <50mA | 50mA |
| Output Impedance | 350 to 700Ω | 1 kΩ ⁵ | 1 kΩ ⁵ |
| Insulation under 50Vdc | ≥100MΩ | ≥100MΩ | ≥100MΩ |

Notes

1. Electrical Termination: Connector output including mate
2. Body in stainless steel or aluminium alloy depending on F.S.
4. Other signal output on request
5. Output impedance < 100Ω on request
6. CE conformance according to EN 61010-1, EN 50081-1, EN 50082-1

FN3050

Load Cell Tension and Compression

DIMENSIONS & WIRING SCHEMATIC (IN METRIC AND IMPERIAL)

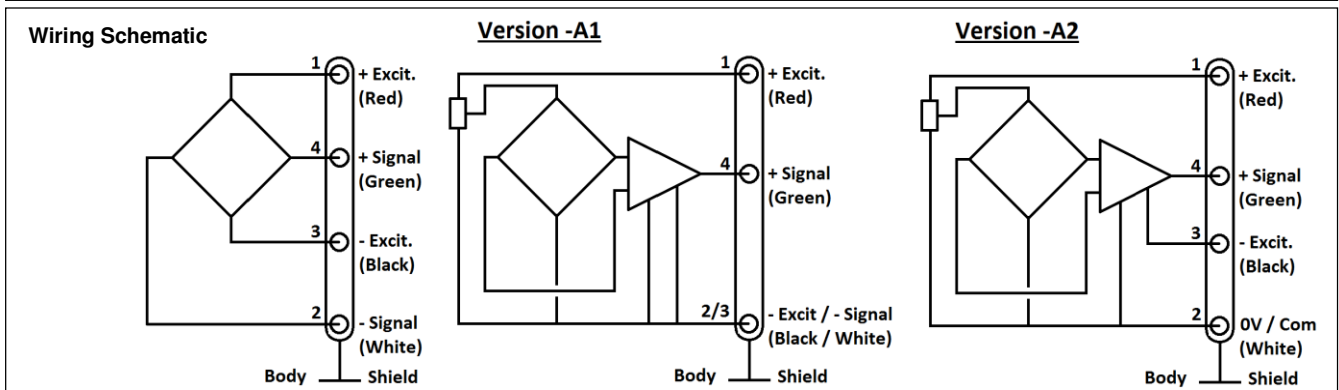
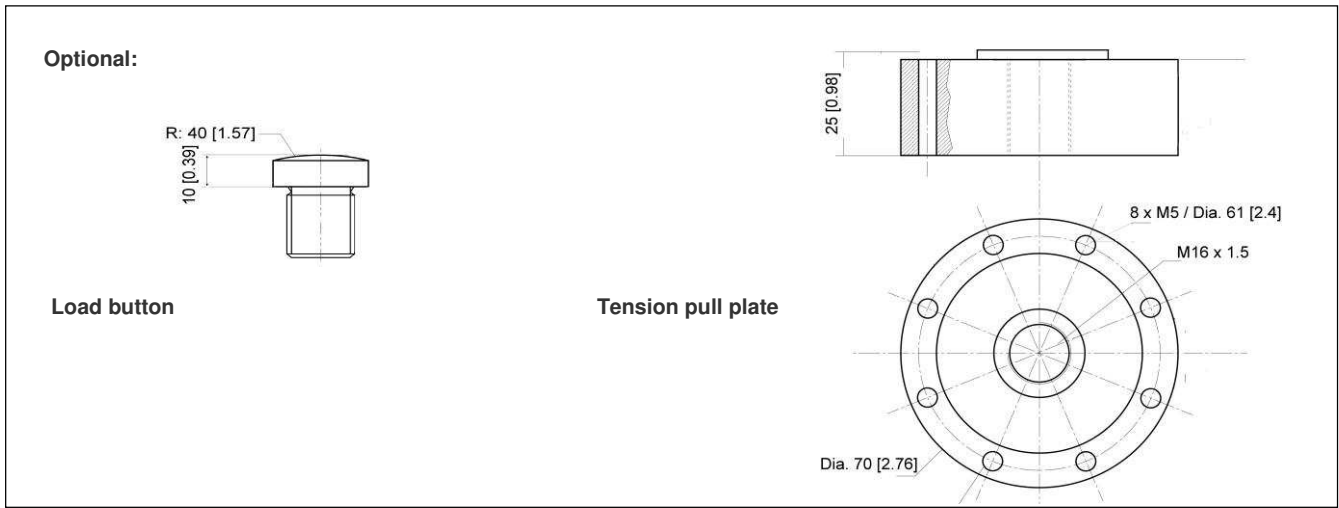
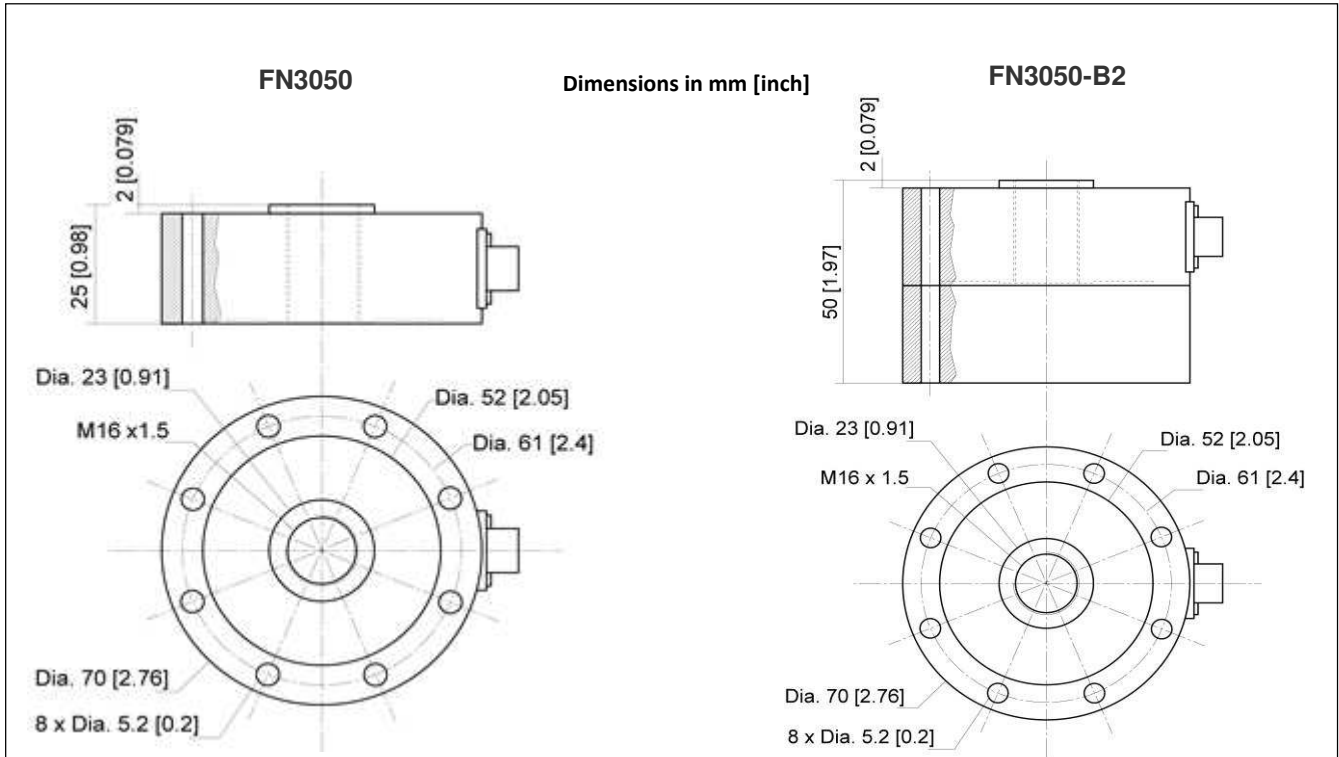

OPTIONS

| |
|--|
| A1 : Amplified Tension output with unipolar power supply |
| A2 : Amplified Tension output with bipolar power supply |
| ET1 : CTR -20 to 100° C [-4 to 212° F] OTR = CTR |
| ET2 : CTR -40 to 120° C [-40 to 248° F] OTR = CTR |
| ET3 : CTR -40 to 150° C [-40 to 302° F] OTR = CTR (Note : ET3 not available with A1 and A2 options) |
| B2 : Mechanical stops (compression only, models ≤2000 N; [≤400 lbf]) |
| PE : Cable Gland Termination with 2 m [6.5 ft] cable |
| PE/L00M : Additional cable length with PE option, replace "00" with total length in meters |

ORDERING INFO

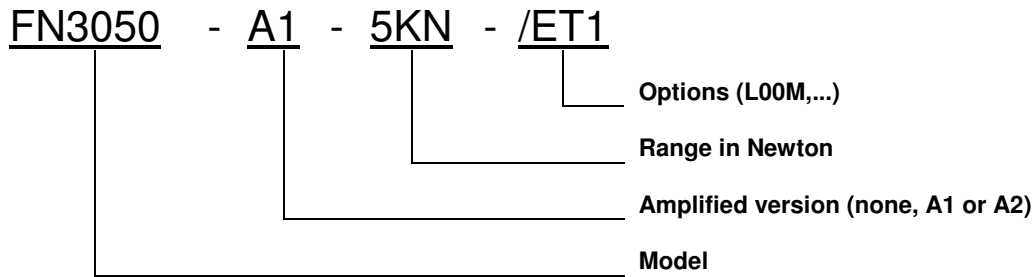

SUPPLIED ACCESSOIRES

| |
|--|
| EFMX-4M : mating plug Jaeger 530-801-006 with clamp 530-841-006 standard and ET1 |
| EFMX-4H : mating plug Jaeger 530-804-006 with clamp 530-844-006 for ET2 or ET3 option |

RECOMMENDED ACCESSORIES

| |
|---------------------------------------|
| EH : Hemispherical load button |
| FF : Tension pull plate |

NORTH AMERICA

Measurement Specialties, Inc.,
 a TE Connectivity Company
 Vibration Design Center
 32 Journey - Suite 150
 Aliso Viejo, CA 92656
 United States USA
 Tel: 1-949-716-0877
 Fax: 1-949-916-5677
 t&m@meas-spec.com

EUROPE

Measurement Specialties (Europe), Ltd.,
 a TE Connectivity Company
 26 Rue des Dames
 78340 Les Clayes-Sous-Bois, France
 Tel: +33 (0) 130 79 33 00
 Fax: +33 (0) 134 81 03 59
 cs.lcsb@meas-spec.com

ASIA

Measurement Specialties (China), Ltd.,
 a TE Connectivity Company
 No. 26 Langshan Road
 Shenzhen High-Tech Park (North)
 Nanshan District, Shenzhen 518057
 China
 Phone: +86-755-33305088
 Fax: +86-755-33305099
 pfg.cs.asia@meas-spec.com

TE.com/sensorsolutions

Measurement Specialties, Inc., a TE Connectivity company.

Measurement Specialties, TE Connectivity, TE Connectivity (logo) and EVERY CONNECTION COUNTS are trademarks. All other logos, products and/or company names referred to herein might be trademarks of their respective owners.

The information given herein, including drawings, illustrations and schematics which are intended for illustration purposes only, is believed to be reliable. However, TE Connectivity makes no warranties as to its accuracy or completeness and disclaims any liability in connection with its use. TE Connectivity's obligations shall only be as set forth in TE Connectivity's Standard Terms and Conditions of Sale for this product and in no case will TE Connectivity be liable for any incidental, indirect or consequential damages arising out of the sale, resale, use or misuse of the product. Users of TE Connectivity products should make their own evaluation to determine the suitability of each such product for the specific application.

© 2015 TE Connectivity Ltd. family of companies All Rights Reserved.